

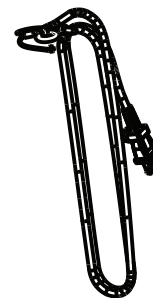

PowerEdge Hard Floor Vacuum

81L2 Series

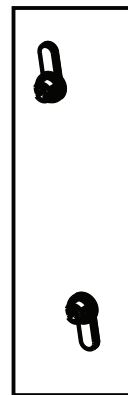
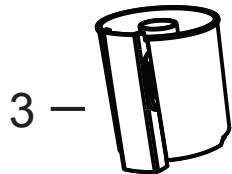
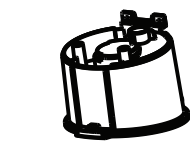
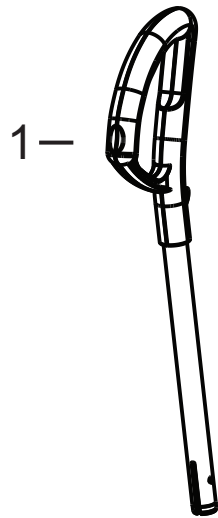

— 6



— 7

PowerEdge Hard Floor Vacuum

81L2 Series



| KEY | PART NO | DESCRIPTION | |
|-----|---------|----------------------------------|--------------------------------|
| 1 | 2030253 | Handle Assembly - Driftwood | |
| 1 | 2030254 | Handle Assembly - Refined Bronze | |
| 2 | 2030251 | Seperator Grill - Kasper Purple | |
| 2 | 2030252 | Seperator Grill - Magenta | |
| 3 | 2030255 | Dirt Cup - Driftwood | |
| 3 | 2030256 | Dirt Cup - Refined Bronze | |
| 4 | 54A2 | Filter Replacement Pack | |
| 5 | 2030250 | Filter Cup Assembly | |
| 6 | 2030257 | Cord Wrap | |
| 7 | 2030264 | Foot Assembly | |
| 7 | 2030265 | Foot Assembly, Pet | |
| xx | 1104251 | User's Guide | 81L2 - Kasper Purple/Driftwood |
| xx | 2031215 | Pre-motor Mesh Filter | 81L2T - Magenta/Refined Bronze |

| | | |
|--|---|--|
| BISSELL Homecare, Inc. (U.S.) Phone: 1-800-457-1509 Fax: 1-800-517-9535 partner.bissell.com | Bissell Canada Phone: 1-800-374-3196 Fax: 1-800-517-9535 Email: schematics@bissell.com | Issued: October 2010 Revised: © 2010 BISSELL Homecare Inc. |
|--|---|--|